



GOVT. OF ASSAM
OFFICE OF THE CIRCLE OFFICER:..... MAJULI REVENUE CIRCLE
KAMALABARI

No. JKC No. 86/2017/

Date - 01 - 12-2017

TO WHOM IT MAY CONCERNED

This is to certified that, the following land details are under possession of Majuli College, Majuli, under Kamalabari Mouza of Majuli District. The land details are as follows:-

Sl No	Village	Dag No.	Area
1	Doria	106	21B- 3K - 19L
2	Doria	508 (Part)	0K - 3K - 0L
3	Dori	510 (Part)	1B - 1 K - 0L
4	UpparKatani	321 (Part)	3B - 0K - 0L
Total			26B - 2K - 19L

This certificate is issued as per report submitted by the concerned Lot Mandal.

Circle Officer,
Majuli Revenue Circle,
Kamalabari.

অসম চৰকাৰ



GOVERNMENT OF ASSAM

চক্ৰ বিষয়াৰ কাৰ্য্যালয় :: মাজুলী কমলাবাৰী ৰাজহ চক্ৰ

মৌজা : কমলাবাৰী

আবেদন নং : MAJ/MAJ/LH/148/2019

তাং : ৩১-০৭-২০১৯

মাটি থকাৰ প্ৰমাণ পত্ৰ

ইয়াৰ দ্বাৰা প্ৰমাণ-পত্ৰ দিয়া হয় যে, মাজুলী কমলাবাৰী ৰাজহ চক্ৰ, কমলাবাৰী মৌজা ব, ওপৰ কাটনী গাঁওৰ ২ নং খেৰাজ ম্যাৰী (এজমালি) পাট্টাৰ অন্তৰ্গত, তলত দিয়া ধৰণে,

দাগ নং	মাটিৰ প্ৰকাৰ	বিঘা	কঠা	লেছা
২৪৩	বিশেষ ফৰিং	১	৪	৪
২৫৫	বিশেষ ফৰিং	২	৪	১০
২৫৬	ৰূপিত	৩	০	৮
৬৭১	বিশেষ ফৰিং	১	০	০

মাটিত মাজুলী কলেজ, (পিতৃ ...) ৰ নিজৰ নামত থকা মাটি হয়।

এই প্ৰমাণ-পত্ৰ লাট-মন্ডলৰ প্ৰতিবেদনৰ ভিত্তিত দিয়া হ'ল।



শ্ৰী অজিত কুমাৰ শৰ্ম্মা, চক্ৰ বিষয়া
মাজুলী কমলাবাৰী ৰাজহ চক্ৰ

Notice :

1) Please note this is a system generated certificate and does not need any signature.

41/2019

BOOK-1/20/2019



सत्यमेव जयते

INDIA NON JUDICIAL Government of Assam

e-Stamp

Certificate No.	: IN-AS06092712634274R
Certificate Issued Date	: 08-Apr-2019 10:18 PM
Account Reference	: CSCACC (GV)/ ascscg07/ AS-MJJAY0031/ AS-MJ
Unique Doc. Reference	: SUBIN-ASASCSCG0709495208952537R
Purchased by	: MAJULI COLLEGE WITH DR DEBAJIT SAIKIA PRINCIPAL
Description of Document	: Article 33 Instrument of Gift
Property Description	: AREA-2B 3K 14L DAG-728 PATTA-165 VILL-OPAR KATANI MOUZA-KAMALABARI CIRCLE-MAJULI KAMALABARI
Consideration Price (Rs.)	: 4,11,000 (Four Lakh Eleven Thousand only)
First Party	: DEBAJIT BORUAH
Second Party	: MAJULI COLLEGE WITH DR DEBAJIT SAIKIA PRINCIPAL
Stamp Duty Paid By	: MAJULI COLLEGE WITH DR DEBAJIT SAIKIA PRINCIPAL
Stamp Duty Amount(Rs.)	: 12,330 (Twelve Thousand Three Hundred And Thirty only)

PRINCIPAL
MAJULI COLLEGE
KAMALABARI

Debajit Boruah



Admissible Under Act, 1908
Correctly Stamped (or exempted from
Stamp Duty) Under the Indian Stamp Act
1899 (Act II of 1899) Rs. 30,825/-

Sub-Registrar, Garamur
Majuli

Please write or type below this line-----

GIFT DEED

THIS DEED OF GIFT is made on this 12th day of April, 2019
BETWEEN

SRI DEBAJIT BORUAH, S/O- Jibeswar Boruah, R/O- Doria Gaon, Mouza-Kamalabari, P/S-Majuli, Dist-Majuli, Assam hereinafter called the Donor of the one part.

AND

MAJULI COLLEGE, College Road Kamalabari, Mouza-Kamalabari, P.O- Kamalabari, P/S-Majuli, Dist-Majuli, Assam, Represented by the Principal DR. DEBAJIT SAIKIA, S/O- Late Jonai Saikia, hereinafter called the Donee of the other part.

TQ 0010375277

Statutory Alert:

1. The authenticity of this Stamp Certificate should be verified at "www.shcilestamp.com". Any discrepancy in the details on this Certificate and as available on the website renders it invalid.
2. The onus of checking the legitimacy is on the users of the certificate.
3. In case of any discrepancy please inform the Competent Authority.



Scanned with OKEN Scanner

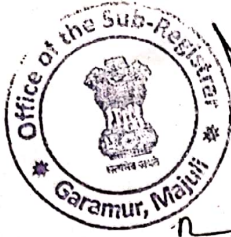

Presented for registration on the 12th day of April, 2019
at Garamur, Majuli.
By Debajit Saikia, Principal of Majuli College.
S/O; D/O Late Jonai Saikia.
Vill: Kamalabari, Kamalabari,
P.S. Majuli, Majuli.
By-Caste: General By Prof: Principal.

Sub-Registrar
Garamur, Majuli

The execution is admitted by the
executors.

Sub-Registrar
Majuli, Garamur

Debasit Borech

Mr Gobin Borech
Gobin Borech

Identified by
RAJA KR. PAIENG
Advocate
Association

Who are identified by...
Shri/Mr./Mam/Ms...
Vill...
P.S...
By Caste... By Prof...

Sub-Registrar
Garamur, Majuli

Debjit Saikia

PRINCIPAL
MAJULI COLLEGE
KAMALABARI



WHEREAS the said Donor is the absolute owner and is in possession of the land tenement herditaments and premises hereinafter fully and specifically described in the schedule hereto and situated at Kamalabari Mouza, Upper Katani Map, P/S-Majuli, Revenue Circle- Majuli Kamalabari, Dist- Majuli, Assam.



AND WHEREAS the said donee is a college name as Majuli College, represented by Principal Dr. Debajit Saikia and Donee wants to do some voluntary works for furtherance of educational activities of the said remote area . And out of such affection is desires of making the Gift of the said tenement, land hereditament and premises in the manner herein after appearing.

NOW THEREFORE THIS DEED OF GIFT WITNESSES as follows:

1. That in pursuance of said intention the said Donor hereby voluntarily without fraud, coercion or undue influence from anybody whatsoever and in full possession of sense . Transfer to the Donee free from all encumbrances whatsoever all the said land with all rights of easement, privileges opportunities' there TO HOLD the same unto the Donee absolutely forever .
2. That the said Donee hereby accepts the said Gift made by the Donor.
3. That the Donor or there heirs/ and successor shall have no interest in the said land.
4. That the said land valued Rs 4,11,000/-(Rupees Four Lakhs and Eleven Thousand) Only.



IN WITNESS HEREOF the said Donor has hereto set and subscribed his signature and delivered in the presence of the witnesses on the day, month and years list above mentioned.

Schedule of the Gifted land:

1. Mouza : Kamalabari
2. Dag No: 728
3. Patta No : 165
4. Land measuring : 2 Bhigas , 3 Kathas, 14 Lossas
5. Land Class- Rupit, Village- Upper Katani Map, P/S- Majuli, Dist-Majuli, Assam.

Bounded by the above land:

1. North by the land :Kamalabari P.H.E
2. East by the land :Majuli College
3. South by the land : Majuli College
4. West by the land : Mohendra Boruah

Witnesses

1. *Sebin Boruah*
Majuli college

Debasish Boruah
Signature of the Donor

[Signature]
Signature of Donee
PRINCIPAL
MAJULI COLLEGE
KAMALABARI

Drafted by
[Signature]
12/04/2019
RAJA KR. PAYENG
Advocate
Majuli Sam Association
G. Amur Majuli

2. *Shri. Lohita Hazarika*
C/o. Sri. Rameswar Hazarika
Vill: Bantani Gaon
P.O. Samati Gaon
P/S. Majuli Dist. No. 1

নং ২৬২০
 মণিপুর চাওঁ
 (মোনা-কমলাবাৰী
 জিলা - মাজুলী-
 বসি:- ৩.২৬ কি.মি:
 চন ২৬-২২-২২
 (ফল ২৬" = ২মাইল

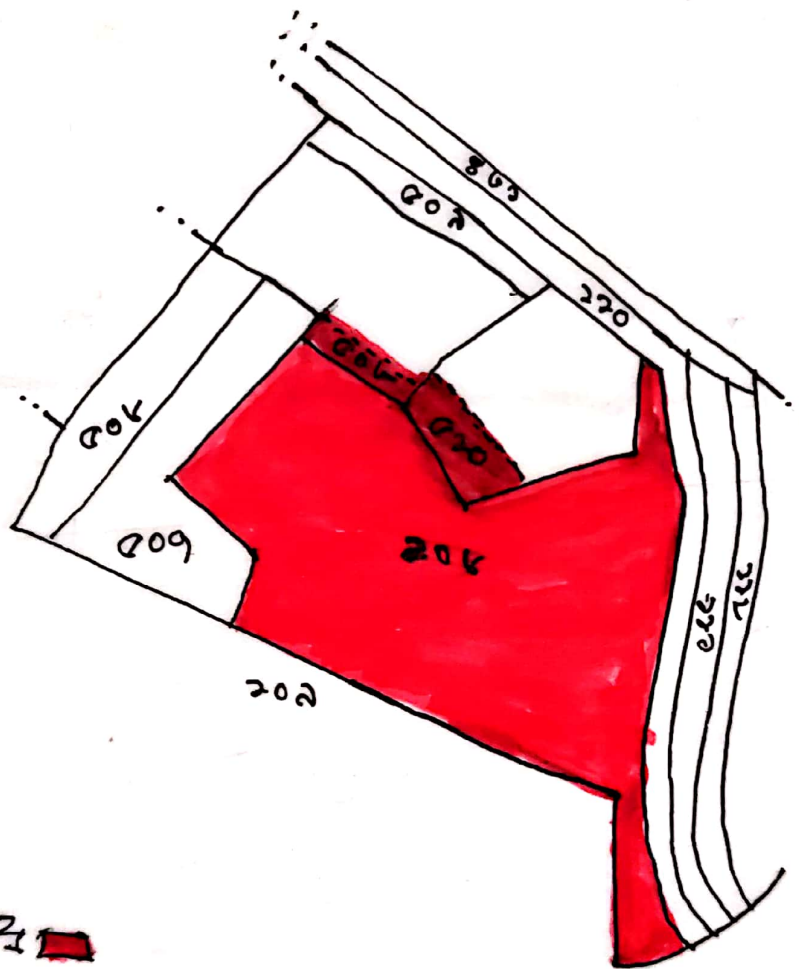

খিৰো চাওঁ চিহ্ন

চাওঁ নং. ২০৬, ২০৭, ২০৮

জি.ও. মণি
ম.ম.

29/07/19

Circle Officer
 Majuli Revenue Circle
 Kamalabari

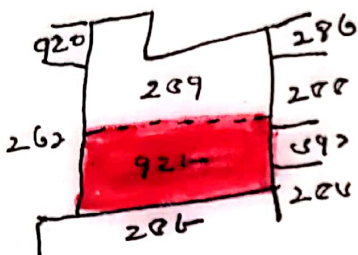
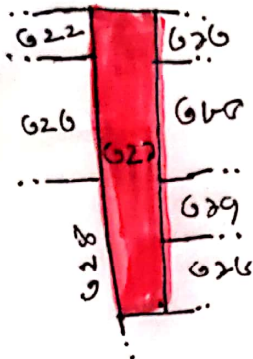

বিহাৰ দাখল হিচাপ

দায়িত্ব -

627
২৮৬, ৯২৬

১৯৬৬
১৯৬৬

29/05/19
Circle Officer
Majuli Revenue Circle
Kamalabari

সং. ২৬২২

উত্তৰ অসম নগৰ
মৌজা-কামলাবাৰী
জিলা-মাৰ্জুলী-

৬৮ ২৬-২২-২২

(ফিল্ড ২৬" = ২২২২
২মি: = ৬.২৬ মি:মি: